

UNITED STATES DEPARTMENT OF AGRICULTURE  
FOREST SERVICE  
DISTRICT 8

116 SANSONE STREET  
~~116 SANSONE STREET, SAN FRANCISCO~~  
SAN FRANCISCO, CALIF.

L  
MONO - Settlement  
Murphy, Louis B, #4

August 14, 1914

Mr. Louis B. Murphy,  
c/o Superintendent Indian Service,  
Bishop, California.

Dear Sir:

Reference is made to Mr. Brothers' letter of  
July 6:

Please let me know whether you wish to remain  
of record for this 40 acres, or amend your application  
to include additional land. This information is needed  
before further action can be taken in the case.

In the absence of a reply within thirty days  
this case will be closed in order to clear the records  
of this office.

Very truly yours,

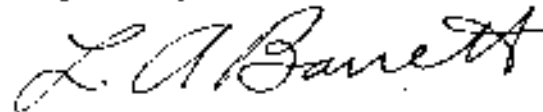

Acting District Forester.

ADDRESS REPLY TO  
"DISTRICT FORESTER"

TELEPHONE KEARNY 5000

UNITED STATES DEPARTMENT OF AGRICULTURE  
FOREST SERVICE  
DISTRICT 5

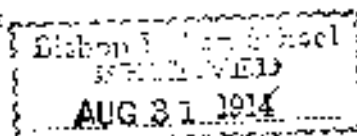

114 SANDOME STREET  
~~FIRST NATIONAL BANK BUILDING~~  
SAN FRANCISCO, CALIF.

L  
Mono - Settlement  
Murphy, Louis B, #4

August 26, 1914

Mr. Ross L. Spalsbury,  
Superintendent Indian Service,  
Bishop, California.

Dear Sir:

Your letter of August 24 is received.

This office has not heard from either the Supervisor of the Mono National Forest or from Mr. Murphy in regard to the areas mentioned by you. It is quite likely that Mr. Murphy intends submitting an amended application for the areas described in his letter to you and that he had Ranger Clark certify to his application. I would suggest that you take the matter up with Mr. Murphy and, if he has not already done so, have him submit an amended application on one of the new forms.

Very truly yours,

*L. A. Barrett*  
Acting District Forester.

Bishop, California.

September 1st, 1914.

Mr. Louis E. Murphy,  
O/c Joseph J. Lent.

Mono Lake, California.

Dear Sir:

Referring to your letter of the 14th ultimo in which you stated that you had taken up the  $\frac{1}{2}$   $\frac{1}{2}$  and  $\frac{1}{2}$   $\frac{1}{2}$ , Sec. 26 T. 1 S., R. 26 E., M. D. M. and that the Forest Ranger Mr. Clark was present, I would state that I have just received a letter from the Acting District Forester, Mr. Barrett of San Francisco, in which he states that nothing has been heard of this so far in that office and suggests that you amend your previous application to cover this land that you now desire, getting the forest ranger Mr. Clark to help you.

Take this letter to Mr. Clark and have him assist you in the preparation of the papers.

Very respectfully,

Ross L. Spaulsby

Superintendent.

In the year 04 Louis Murphy ( Indian) received a "rust patent" to 130 acres lying partly in Sec. 26, Tp 1 N, R. 26 E.; M.D.S. & M. and partly in Sec. 35 same township.

Prior to his making claim to the land it had been occupied and part of it cultivated by other Indians, one whose Indian name sounds like "Macner-bow-o" died twenty five years ago, leaving two daughters, one of them called Mary Charley another called Rosie, both of whom have continued most of the time to cultivate and occupy the portion of the land lying to the Westward of Rush Creek which crosses the land diagonally from South West to North East.

The other Indian was called Joe-bow-go-ah, and he died about the time Louis Murphy got the land, leaving a daughter called Mary Schwager who as her father, has occupied, cultivated, and claimed ( Indian fashion) a portion of the land lying on the right bank of the said Rush creek.

Wishing to surrender the land to these women, Louis Murphy had been trying to find and obtain another suitable tract. He tried to get ~~the~~ one <sup>and Sixty</sup> hundred acres in Section seventeen of Tp. 1. S., R. 26 E., viz the  $W\frac{1}{2}$  of NE and  $E\frac{1}{2}$  of NW, but the District Forester objected on the ground that the land lies above the seven thousand foot contour, and was unsuitable for cultivation. ~~As a matter of fact,~~ the principal part of the tract lies below the 7300 ft contour, and on the West side of Parker creek where it gets the benefit of the morning sun, and within what appears to be a sort of thermal belt as strawberries, gooseberries, wild plums, <sup>and</sup> wild blackberries grow there.

Bridgeport Tom ( Indian) at about the same elevation raises good wheat barley, rye, Potatoes, onions, radishes and lettuce, as well as some other things, and George Sam, another Indian raises about the same things, and both of them raise alfalfa, and all between the seven thousand and seventy five hundred contours.

As an alternative, Louis Murphy selected a tract in Sec. 5, (the  $E\frac{1}{2}$  of SE $\frac{1}{2}$  and SE $\frac{1}{2}$  of NE $\frac{1}{2}$ ), but the objection was raised that there was no available water. ~~Another alternative tract was~~

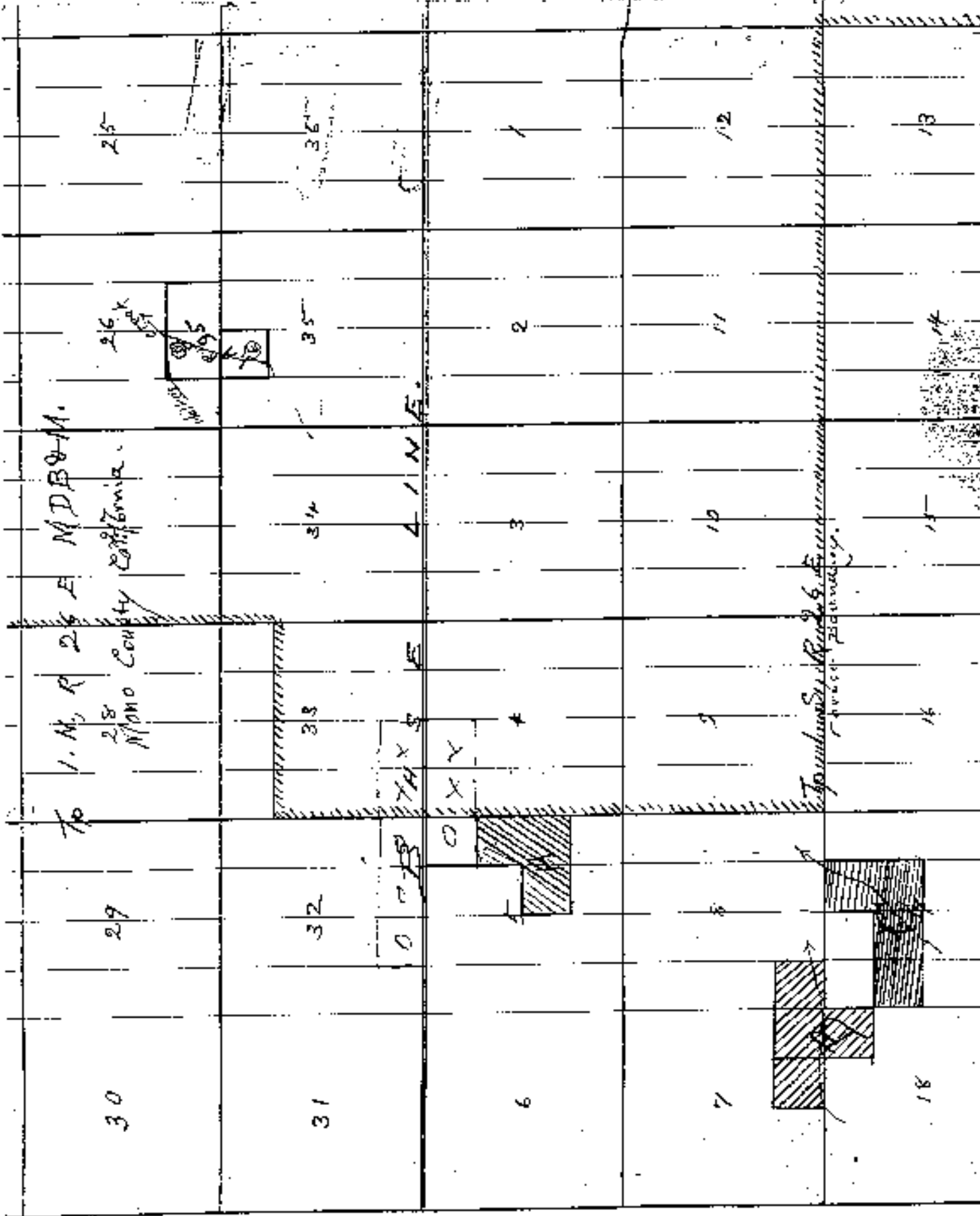

1. M. R 26 E M.D.B.M.

28 Mono County California

25

36

1

12

13

26

35

2

11

14

34

LINE

3

10

11

To

29

33

TH X S

4

9

16

To

30

32

O C B

6

7

18

31

X X

O

To

Bishop Indian School  
RECEIVED  
MAY 3 - 1915

Dear Sir

Reserton California

Mr. Ross L. Spalding

May 14 - 1914

I thought it would drop you a few lines to let you know about me I did not plant anything this spring I wish you come up and get the land me I want to plant some wheat in that place and potatoes too on this month

Will you send you might come up on this month with next week I'll go over there to Crater Cal.

I am going to wait for you over there at farington when you get there ask Mrs farington where I should go up there I am going stay down until this before you come up, you write little to me send Crater or farington Nevada  
I'll try to get this letter you answer soon, as you can as possible

From your truly

Louis B. Murphy  
Indian

Bishop, California.

May 8th, 1916.

Mr. Louis B. Murphy,

Hono Lake, California.

Sir:

I have your letter of the 1st instant regarding certain land you wish to get near Hono Lake.

I will have some surveyors there in a week or two to do some surveying and would suggest that you hand this letter to them and they will probably be able to help you make your selection. I am uncertain just when I will get up there as it depends altogether on the date the court meets for that water trial in Bridgeport.

Very respectfully,

**Ross L. Spalsbury**

Superintendent.

MAY 19 1916  
RECORDED  
Mohon Indian School

Benton, Calif., May 11, 1916

Ross L. Spalsbury,  
Bishop, Calif.,

Dear Sir;

Louis E. Murphy (Indian) consults me regarding a tract which he recently received from the District Forester of in which the said D.F. tells Murphy that the land applied for in the Mohon Forest is non-listable under act of June 11, 1906, for following reasons: "It is above 7,500 ft elev. Winters severe, snowfall extremely heavy" "Growing season short. Very little rain during growing season, and but little to occur at any time of year. No land of similar character is being cultivated. The land is chiefly valuable for grazing and the greater part of it is needed in connection with grazing administration of Forest."

And adds, that rejection of appl'n will not deprive him of right to apply for other lands within Nat'l Forest, etc. and grants thirty days within which to file petition for review, said filing to be with Dist. Forester. Registered letter received by Murphy, about last Friday, (21st).

My plat book does not show entries in Tp. 1 S., R. 26E, but does come in 1 N. 26E, sketching them on the Mount Lyell Topog. Sheet, Murphy recognizes George San's and Bridgeport Tex's places. George San's place is apparently at the same elevation as the land which Murphy wants, viz below the 7500 ft.

Not having the description of the land wanted by Murphy, I cannot say it, so cannot be certain. My idea is, to show, as Murphy claims, that the land really grows wheat, rye, potatoes, onions, turnips.

From what Murphy says, it appears to me that the tract desired by him probably is what may be called a "thermal belt", and be susceptible to cropping, when other land of like elevation in less favored spots would not be.

Believing that it may be practicable to secure this land for Murphy, in spite of the D.F.'s declaration, I write this to you for the purpose of helping along as well as I may.

Yours respectfully;

Samuel J. Alderman

RECORDED  
INDEXED

11



Bishop, California.

May 26th., 1915.

The Commissioner of Indian Affairs,

Washington, D. C.

Sir:

Some time ago Louis B. Murphy, Indian, applied to have the S/2 of the NE/4 and the N/2 of the SE/4, Sec. 17, T. 1 S., R. 26 E., M.D.M., lying within the Mono National Forest, listed for entry on his behalf. Murphy already has an allotment, but owing to the antagonism of the other Indians desires to relinquish it. I advised him to get the way cleared for filing on another piece of land before he should relinquish that piece which he already has, and acting on that advice he made the application.

He is now in receipt of a communication from the District Forester, rejecting his application for the following reasons:

"It is above 7,500 feet elev. Winters severe, snowfall extremely heavy. Growing season short. Very little rain during growing season, and frosts liable to occur at any time of the year. No land of similar character is being cultivated. The land is chiefly valuable for grazing and the greater part of it is needed in connection with grazing administration of Forest."

These reasons are not well taken, in my opinion, for there is another Indian in that vicinity whose land lies at the same elevation as that for which this Indian applies, and the Indian who already has a ranch grows grain and garden vegetables without any difficulty.

It is suggested that this matter be taken up by the Office with the view of getting the Indian permission to file on this particular piece of land.

It seems that Murphy received his notice Friday May 14th., and he has 30 days from that date to file a petition for review with the District Forester.

Very respectfully,

Ross L. Spaulbury  
Superintendent.

RIS/IRL.

REFER IN REPLY TO THE FOLLOWING:

Land-Allotments  
60871-1915  
W A M

## DEPARTMENT OF THE INTERIOR

OFFICE OF INDIAN AFFAIRS

WASHINGTON

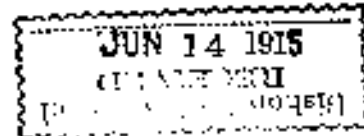

JUN -9 1915

Mr. Ross L. Spalsbury,

Supt. Bishop School.

My dear Mr. Spalsbury:

Your letter of May 26, 1915, in regard to the application of Louis B. Murphy, an Indian, to be allotted certain lands within the Mono National Forest, has been received.

Before the Office can take definite action on this case you are requested to furnish the descriptions of his present allotment and to report whether or not it is also located within a national forest. You should also show whether or not he is now living on or has made improvements on the lands which he now desires to be allotted. There are acts of Congress which would authorize an Indian who has one allotment to relinquish his lands and to apply for other lands in lieu thereof, and possibly if the local officers will withdraw their objection to the allotment of the lands now wanted by the Indian, that the change may be made. At any rate, the Office suggests that the local forest officers be requested to forward the application through the usual channel to the Department of Agriculture so that it will reach this Office in due time, when opportunity

will then be had to take up the matter with the Secretary of the Interior, with an appropriate recommendation as to what action should be taken to protect the interests of the Indian.

A copy of the regulations governing Indian allotments in national forests is enclosed herewith.

Very truly yours,



Second Assistant Commissioner.

6-JH-8

Bishop Indian School  
RECEIVED  
JUN 15 1915

Dear Sir \_\_\_\_\_ Crater \_\_\_\_\_  
New Rose, Alaska June 11<sup>th</sup> 1915

I received your kind letter to me  
with which you were so kind  
to trouble me and I am sure  
I like you that I can't say  
like plant anything more  
to planting and I am sure  
with distinct frost days in  
land to high elevation of 7500 feet  
and the growing season very short  
too he said Mrs. Lutz  
she got more high and that  
I tried get and Stegman  
and Geo. Lamm too

Well, have been <sup>long</sup> getting green  
now up. These very good,  
good for the cow and horse  
if I get that land I keep  
my horse in there and I'll  
get cow I keep in there too  
and the season is not very  
short any thing growing good  
up there more butter than here  
at North Creek

I like that place better than here  
any warm nice ground is good  
I do not like down prairie  
valley, ground is not much good  
down here, I think you want  
me get other place, has like  
that way, Well I'll leave in  
Winter good bye  
From your truly James G. Murphy